



Series X00

hermetically sealed magnetic coupled rotary vane pump

Introduction

The rotary vane pumps are positive displacement volumetric pumps, designed for pumping water and aggressive liquids with low flow at high pressure. The X00 series pump units are hermetically sealed / magnetic coupled.

Applications

- Pumping dangerous and radioactive liquids
- Transfer of solvents, acids, alkalies, refrigerants
- Sampling, system circulation pumps

Available materials of construction

- AISI 316 or 316L SS
- Incoloy 825
- Hastelloy C276

Features

- Hermetically sealed unit
- Dry self priming up to 3m (10ft)
- Very high viscosities up to 2000 cPs
- Re-enforced carbon cartridge
- Carbon or silicon carbide sleeve bearings
- CENELEC drive motor in EEx-d-IIB T3 execution

Options

- Silicon carbide sleeve bearings
- High temperature design (up to 250°C)
- Flanged ports
- EEx-d-IIC T3 drive motor
- Complete skid assembly
- ATEX execution

Flow 80-2000 l/h (0.35-11GPM)

Head 15 Bar (250 PSI)

Temperature -70°C + 180°C (-100F +356F)
-250°C (480F) optional

System Pressure 25 Bar (350 PSI)

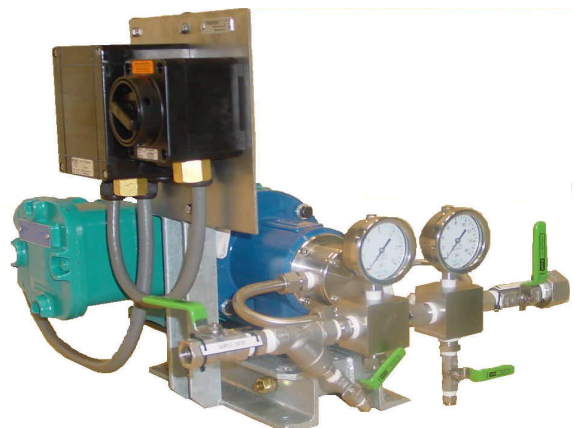

*Customised pump skid with model 200
hermetically sealed pump unit and full options*



Series X00 hermetically sealed sliding vane pumpunit

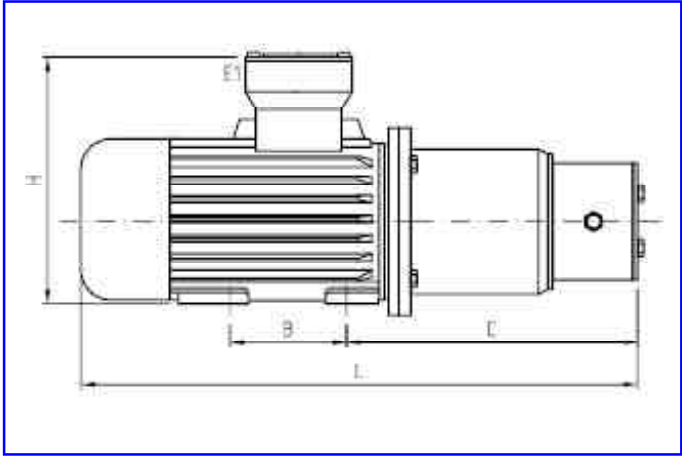
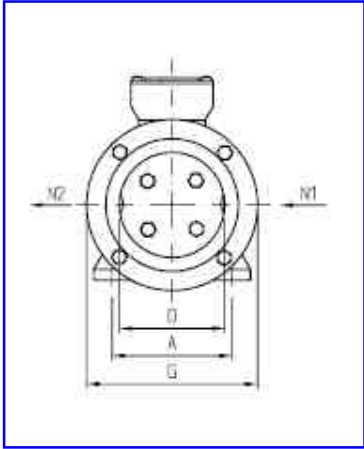

Series 100 / 200 / 300 / 400 / 600 / 800

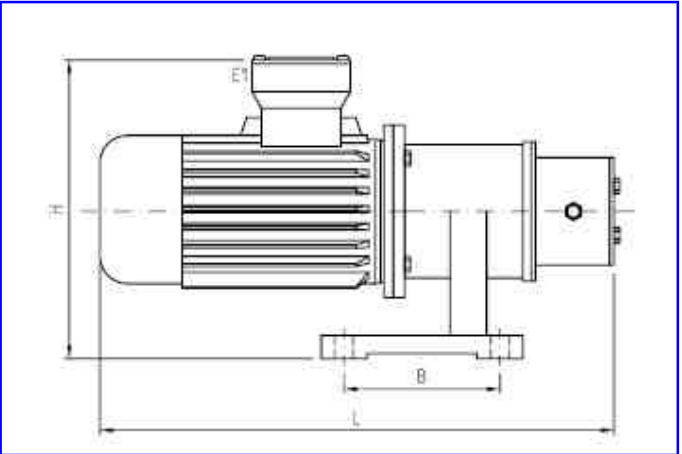
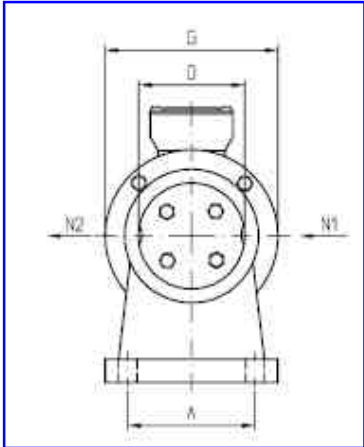

Series 1000 / 1500 / 2000

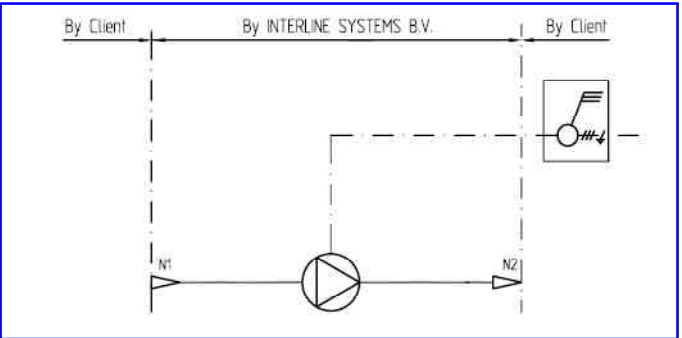

Pump series	A	B	C	D	G	H	L	N1/N2 NPT-F	E1 POWER
100/200/300/400	112	90	198	70	160	220	418	3/8"	M20x1,5
600/800	125	100	254	95	200	258	480	1/2"	M20x1,5
1000/1500	140	125	312	123	200	275	566	3/4"	M20x1,5
2000	160	140	319	123	200	317	636	3/4"	M20x1,5

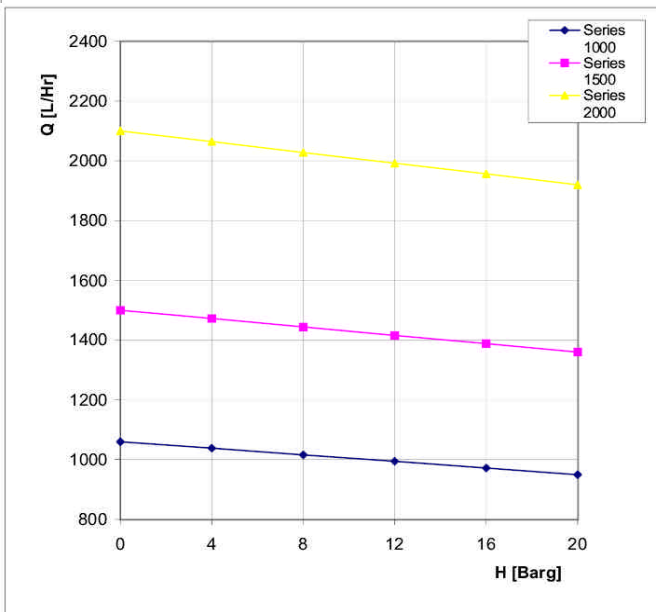
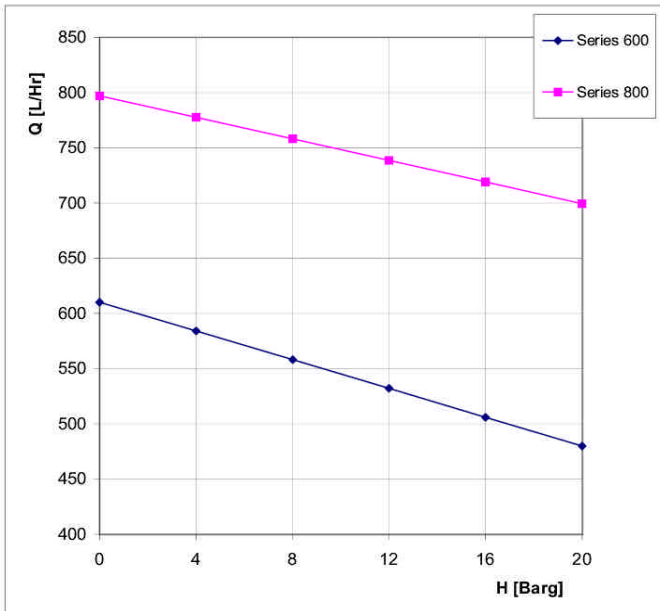
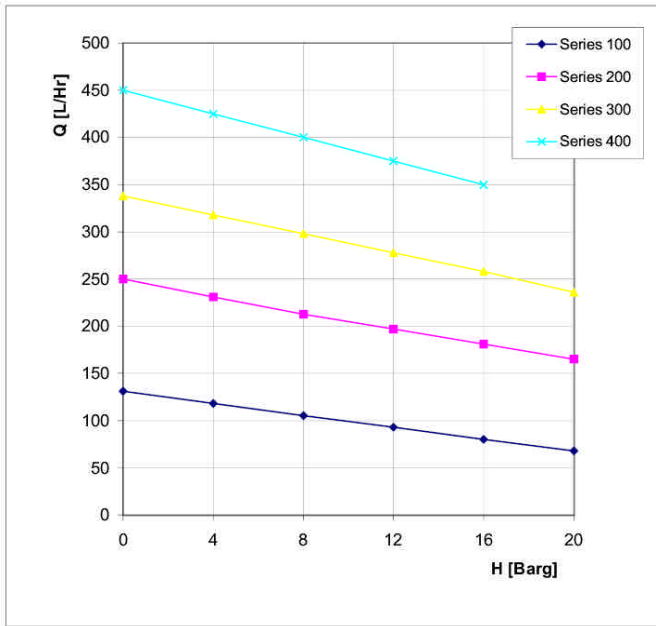

Specification

System pressure

25 Barg max

Discharge pressure

Graph is reflecting performance with C type coupling.

For A type coupling discharge pressure is limited to:

- Series 100-A: 14 Barg
- Series 200-A: 12 Barg
- Series 300-A: 10 Barg
- Series 400-A: 8 Barg
- Series 600-A: 14 Barg
- Series 800-A: 12 Barg
- Series 1000-A: 14 Barg
- Series 1500-A: 14 Barg
- Series 2000-A: 12 Barg

Consult works for critical applications.

Curve based on 50Hz drive motor (1450 RPM) with medium: water

Exploded view

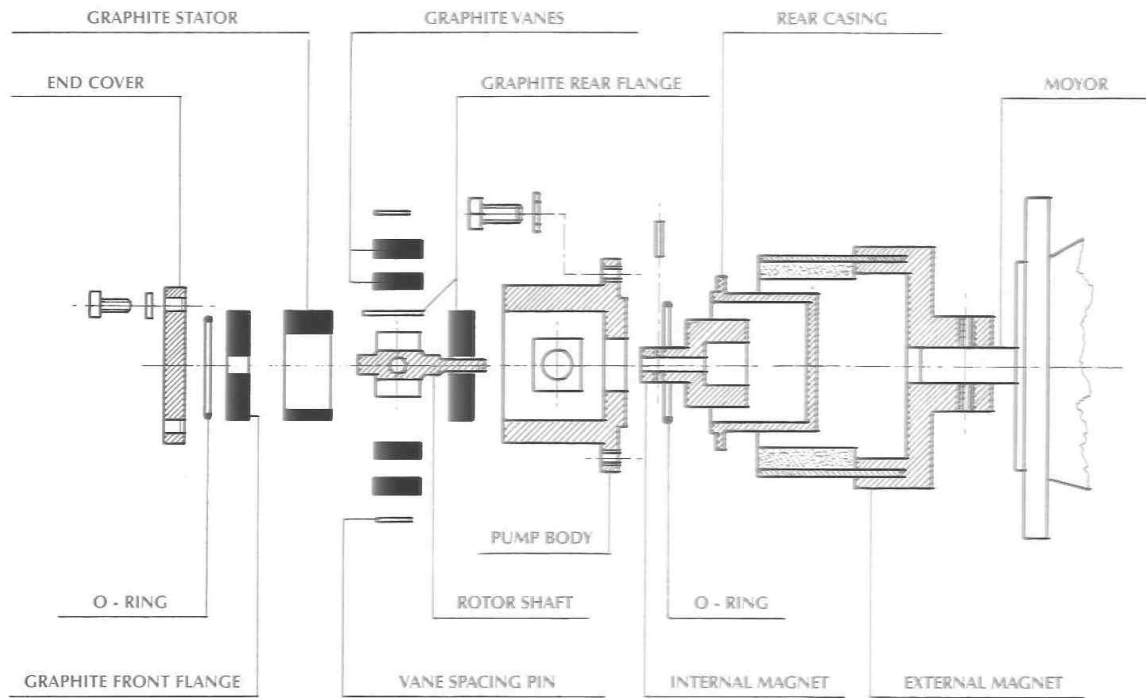

*Interline Systems BV has adopted the policy of continuous product development.
Although this bulletin has been compiled with great care, current standard executions may deviate.*



Interline

Interline Systems BV

Ampèrestraat 3
1704 SM Heerhugowaard
tel. 00 31 (0) 72 576 08 40
fax. 00 31 (0) 72 576 08 44

Internet: www.interline.nl
E-mail: info@interline.nl