

# soli::lyser I

- s::can plug & measure
- measuring principle: optical (infrared absorbance)
- ideal for waste water
- soli::lyser I monitors TSS
- long term stable and maintenance free in operation
- factory precalibrated (2 measuring ranges available)
- automatic cleaning with compressed air
- mounting and measurement directly in the media (InSitu) or in a flow cell
- operation via s::can terminals & s::can software
- minimal maintenance (no waste parts)
- most cost efficient sensor, cost of ownership are unmatched

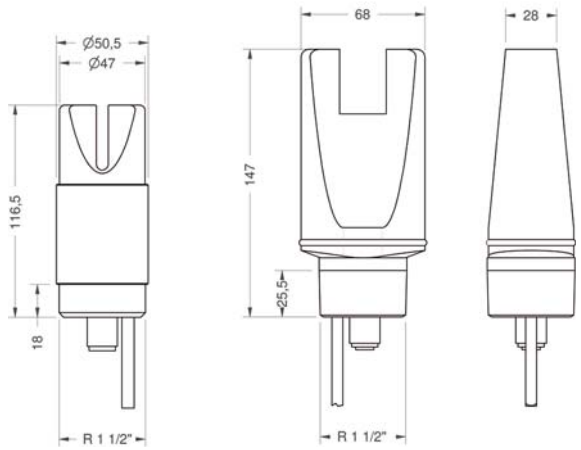

recommended accessories	
part number	article name
F-11-oxi	carrier oxi::lyser™ and soli::lyser
F-44-oxi	flow cell for oxi::lyser™ and soli::lyser
F-50-3-eco	system panel for s::can oxi::lyser, soli::lyser or s::can sensors
F-50-3-pro	
C-210-sensor	10 m extension cable for s::can sensors and s::can ISE probes
B-44	cleaning valve



### technical specification

measuring principle	optical	cable type	22 AWG, polyurethane jacket
measuring principle detail	infrared (880nm)	housing material	epoxy, stainless steel
measuring range application	0.25 ... 30 g/l TSS 0 ... 1500 mg/l TSS	weight (min.)	540 g
resolution	10 mg/l between 1000 and 9999 mg/l 100 mg/l above 10 g/l 1 mg/l below 1000mg/l	dimensions (diameter x length)	51 mm x 160 mm
accuracy	5% of reading	operating temperature	0 ... 60 °C
repeatability	± 1 %	operating pressure	0 ... 6.8 bar
automatic compensation instrument	temperature	installation / mounting	submersed or in a flow cell
response time	60 sec.	process connection	R 1 1/2"
integration via	con::lyte 1 con::lyte 2 con::lyte 4 con::nect con::stat	protection class	IP 68
power supply	6 ... 16 VDC	automatic cleaning	media: compressed air permissible pressure: 2 ... 4.5 bar air volume: 5 ... 10 liters per cleaning cleaning duration: 4 ... 12 seconds per cleaning cleaning interval: depending on application
power consumption (max.)	0.32 W	conformity - EMC	EN 50081-2, EN55011
interface connection to s::can terminals	sys plug, IP 68, RS485, 12 VDC	conformity - safety	EN 61000-4, EN61010-1
cable length	10 m	extended spare part warranty (optional)	2 years

### municipal WWTP influent

		typical concentration ranges for this application	
		TSS [g/l]	part number
soli::lyser (TSS)	min.	0.25	E-505-1
	max.	30	

### municipal WWTP aeration

		typical concentration ranges for this application	
		TSS [g/l]	part number
soli::lyser (TSS)	min.	0.25	E-505-1
	max.	30	

### municipal WWTP effluent

		typical concentration ranges for this application	
		TSS [mg/l]	part number
soli::lyser (TSS)	min.	0	E-505-2
	max.	1500	